



Sink - VAIA

Lavatory spout, wall-mounted without drain - polished chrome

Article number: 13 800 809-00 0010



- 7-1/2" Projection
- Rigid spout
- Round aerated stream
- 1-1/2" hole diameter
- Flange diameter 2-3/8"
- 1/2" connection
- Plug-in connection mounting
- Water flow rate limited to max. 1.2 gpm
- lead-free

Codes & Standards

- NSF/ANSI 372
 - California Energy Commission (CEC)
 - ASME A112.18.1/CSA B125.1
 - NSF/ANSI/CAN 61
-
- For Touchfree control please order eSet Touchfree WITH or WITHOUT temperature adjustment

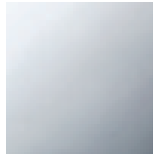

polished chrome



Accessory is required for this item.

Discontinued items available to order until 31.12.9999



Sink - VAIA

Lavatory spout, wall-mounted without drain - polished chrome

Article number: 13 800 809-00 0010

Dimensional drawing

mm [inches]

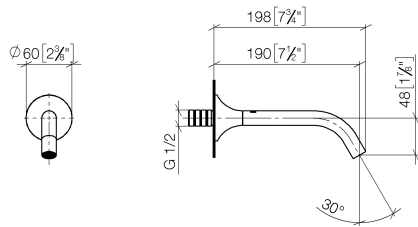

All dimensions in mm / inch = mm x 0,0394

Flow rate chart

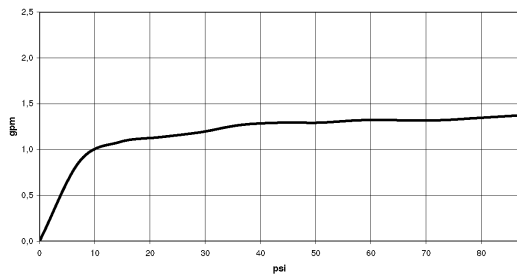



Sink - VAIA

Lavatory spout, wall-mounted without drain - polished chrome

Article number: 13 800 809-00 0010

Other surface finishes



platinum matte

13 800 809-06 0010



platinum

13 800 809-08 0010

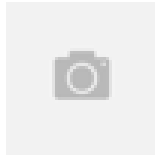

Brushed Durabrass

13 800 809-28 0010



Dark Platinum matte

13 800 809-99 0010

More custom finish options are available via special production (xTra Service). Please see our finish matrix for availability and pricing or contact a Dornbracht representative.



35 080 970-90 0010

Rough-in adapter -



Sink - VAIA

Lavatory spout, wall-mounted without drain - polished chrome

Article number: 13 800 809-00 0010

Spare parts list

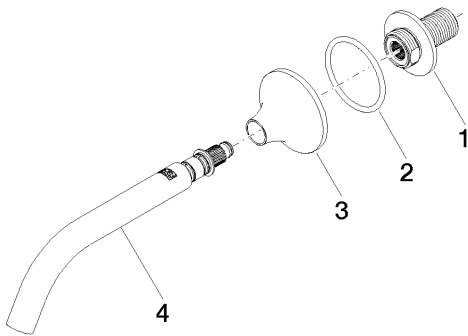

Number	Item Number	Designation	Number of units
1	09 24 03 269 90	nipple	1
2	09 14 10 084 90	seal	1
3	09 27 80 011-00	rosette	1
4	90 28 22 310 01-00	spout	1